

# 317L A.C. & ALT.

A.C. COMPRESSOR AND ALTERNATOR MOUNT  
235 CU. IN. 1953-54 6-CYL.CHEVY- DRIVER'S SIDE



1. Remove generator, mounting bracket, and adjusting arm.
2. Install the compressor bracket in place of the generator bracket using two 3/8 x 3/4" Bolts.
3. Mount the compressor to the bracket using two 3/8 x 1 1/2" bolts and two 3/8" nylock nuts. **Note:** The compressor line fittings should be positioned towards the inner fender panel of the vehicle (1 and 2 o'clock position).
4. Remove lower water pump bolt. Install the compressor adjusting arm (Shorter arm) to the lower water pump Using a 3/8 x 1 3/4" bolt with the .150 spacer between the adjusting arm and water pump. Use 1 1/2" bolt, 3/8 Flat washer and 3/8 nylock nut to attach adjusting arm slot to compressor tab.
5. Remove upper water pump bolt and drivers side thermostat housing manifold bolt. Install alternator front plate (triangular shape) and alternator adjusting arm using 3/8 x 2" bolt at upper water pump (note the stepped portion of the front plate installs at water pump). Use 3/8 x 1 3/4" bolt and .250 spacer at thermostat housing manifold to install upper front plate and alternator adjusting arm.
6. Remove the front intake exhaust manifold hold down, and install the L-shaped rear alternator bracket to the manifolds using a 3/8 x 3/4" bolt and original hold down tab. Install lower alternator pivot between front plate and rear alternator Bracket using 3/8 x 3/4" bolt, .150 spacer and 3/8 Nylock nut.
7. Install alternator adjusting arm slot to top mounting boss of alternator using 5/16 x 1" bolt and 5/16" flat washer.
8. Install the short belt around the rear compressor groove and alternator. (Dayco #15330)
9. Install the long belt around the front compressor groove, crank and water pump pulleys. Tighten the compressor belt and then the alternator belt. (Dayco #15440)

**27070 METCALF ROAD LOUISBURG, KS 66053**

**(913) 837-4368**



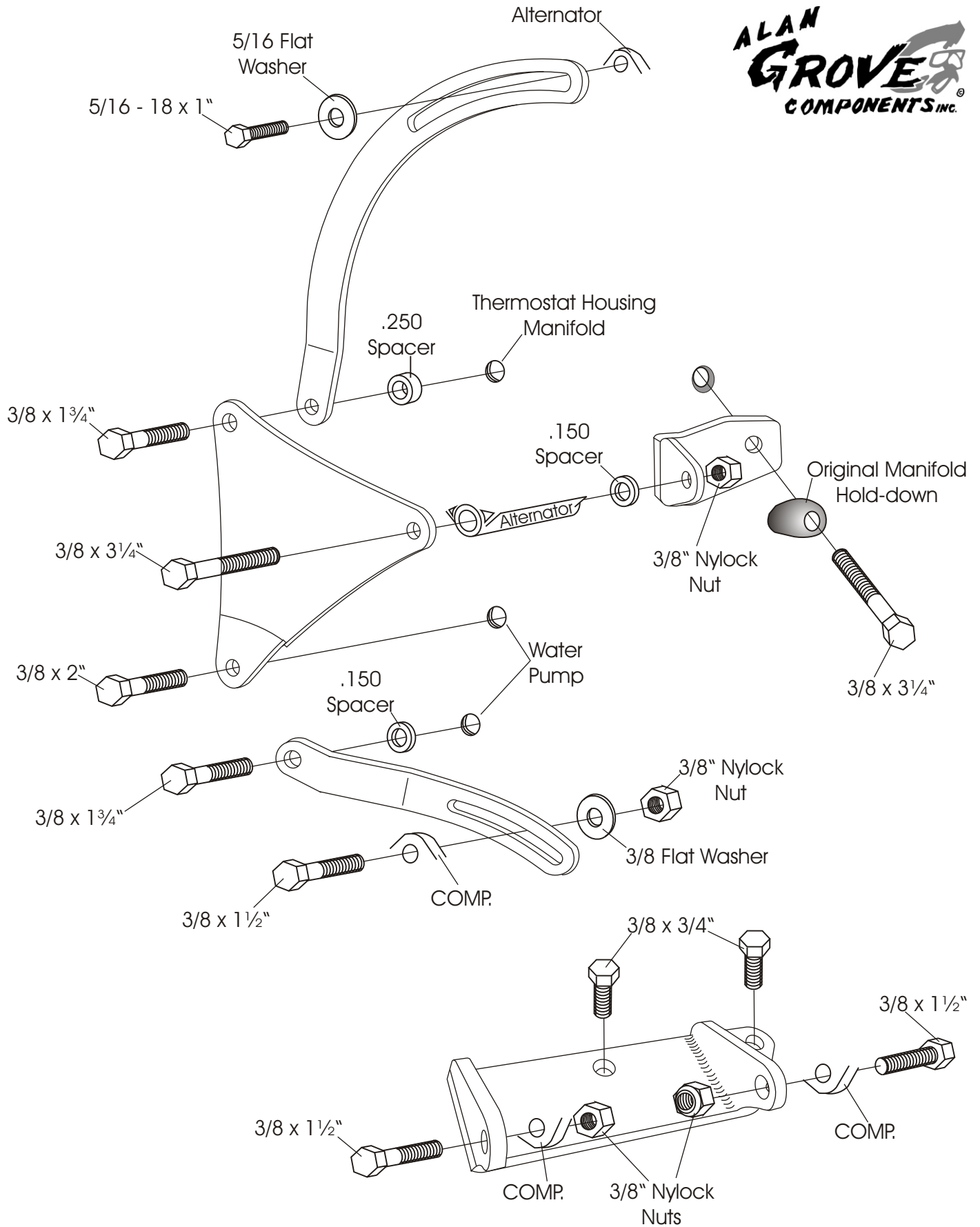

**As with any part of this nature, make sure it fits your application before painting or plating. Parts that have been painted, plated, or modified may not be returned.**

A.C. & ALT.  
MOUNT  
317L  
1953-54 CHEVY  
235 CU. IN. 6-CYL.  
DRIVER'S SIDE

**ALAN GROVE COMPONENTS, INC.**  
**27070 METCALF ROAD**  
**LOUISBURG, KS 66053**