

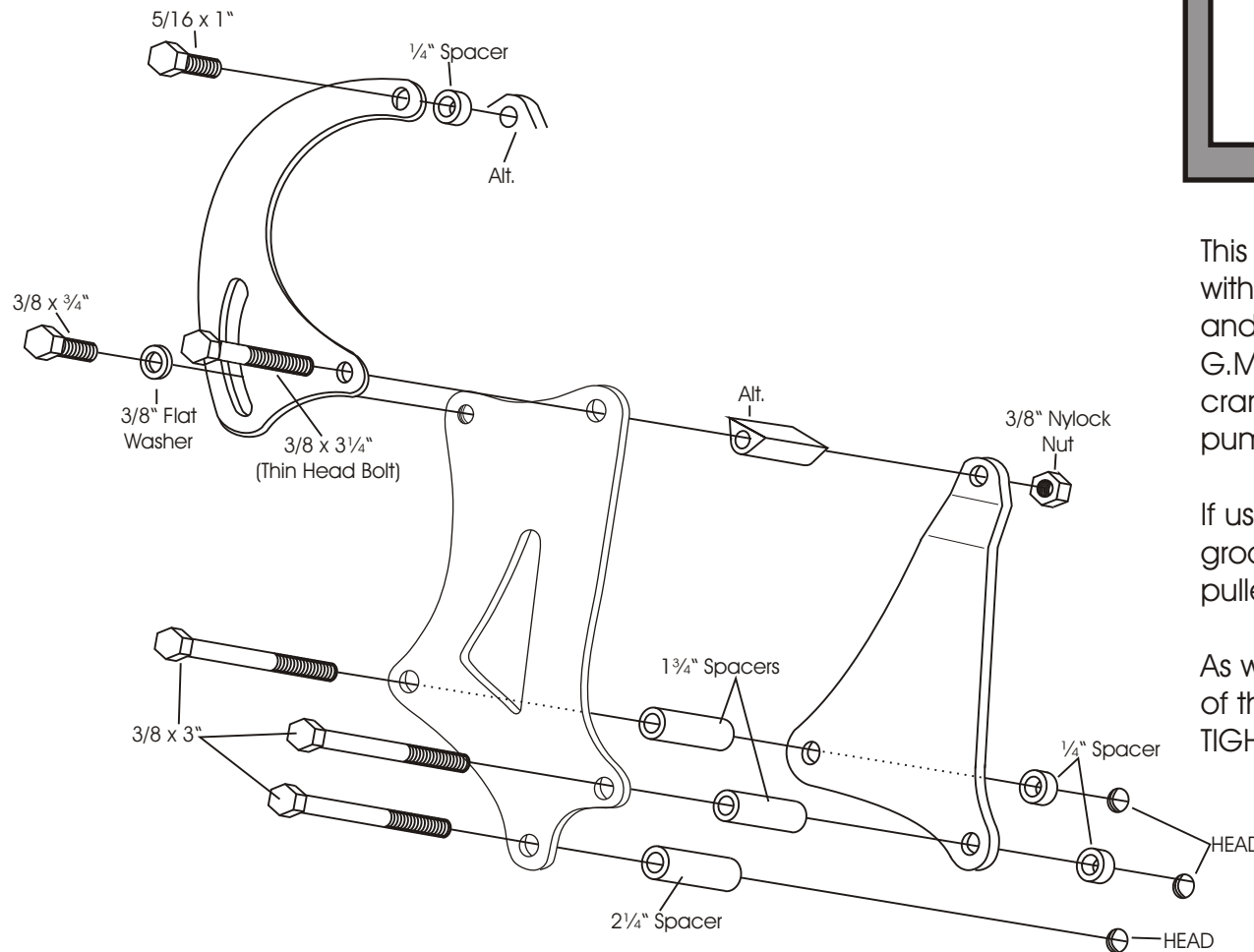

We use a belt length of 57 - 58" with this mount on installations in our shop. However; this can vary with the diameter of your pulleys.

# ALTERNATOR MOUNT 238L

348-409 Chevy - Driver's Side



This Bracket was designed to be used with Chevrolet double groove crank and water pump pulleys. The current G.M. Part Numbers are 3744043 for the crank and 3995642 for the water pump.

If using alternator mount only, single groove water pump and crank shaft pulleys may be used.

As with any mount system, assemble all of the brackets to engine BEFORE TIGHTENING THE BOLTS.

**As with any part of this nature, make sure it fits your application before painting or plating. Parts that have been painted, plated, or modified may not be returned.**

ALTERNATOR  
MOUNT

238L

348-409 Chevy - Driver's Side

**ALAN GROVE COMPONENTS, INC.**  
**27070 METCALF ROAD**  
**LOUISBURG, KS 66053**