

# ALTERNATOR MOUNT 218R

**Big Block Chevy - Short Water Pump Passenger Side - Wide Mount**

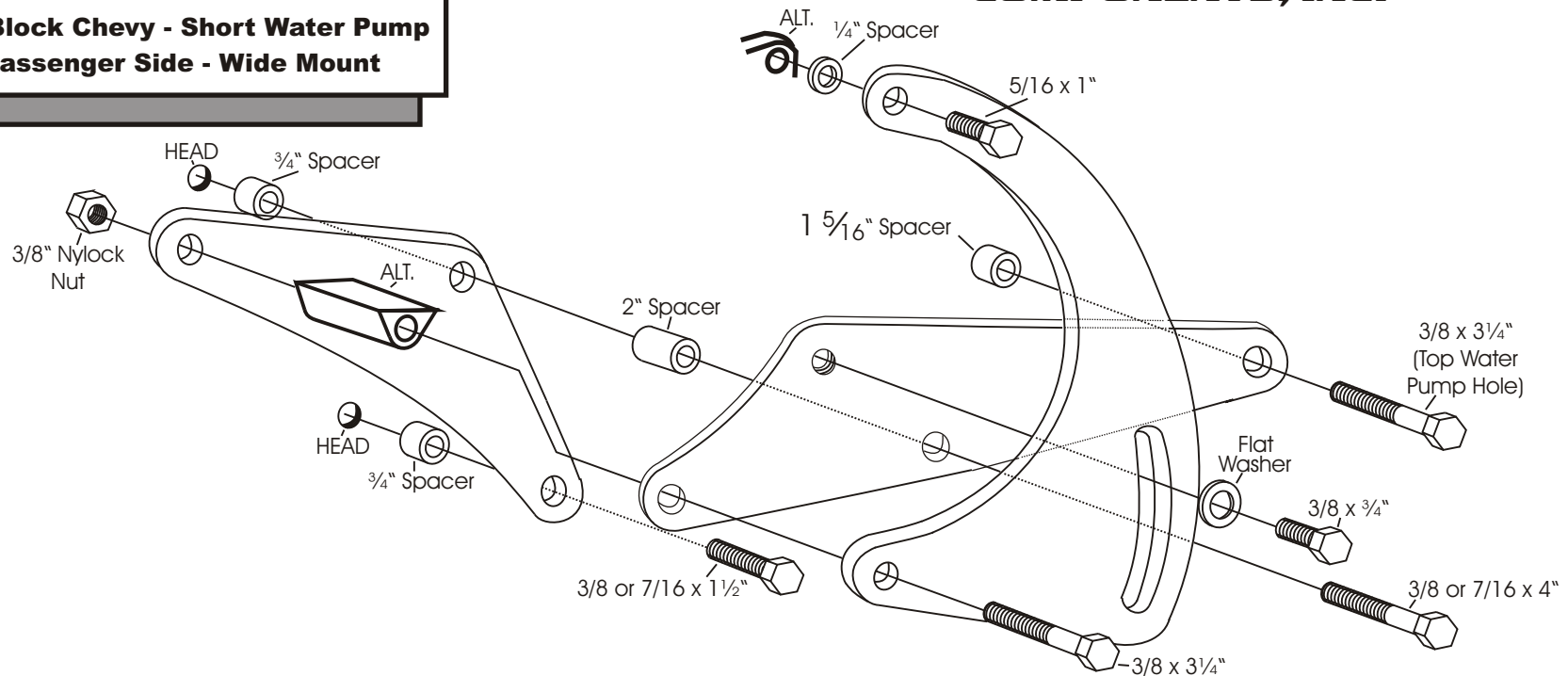

(We use a belt length of 58-59" with this mount on installations in our shop. However; this can vary with the diameter of your pulleys.)

**As with any part of this nature, make sure it fits your application before painting or plating. Parts that have been painted, plated, or modified may not be returned.**

**NOTE:** Some heads have 3/8" bolt holes and some have 7/16". This kit includes both sizes of bolts for these holes.

If your head has 7/16" it will be necessary to enlarge the corresponding holes in the mount to 7/16".

When installing the mount, start all bolts and mount the compressor before tightening.

ALTERNATOR  
MOUNT

218R

**Big Block Chevy - Short Water Pump  
Passenger Side - Wide Mount**

**ALAN GROVE COMPONENTS, INC.  
27070 METCALF ROAD  
LOUISBURG, KS 66053**