

# A.C. COMPRESSOR MOUNT 138R

348-409 Chevy- Passenger Side

We use a belt length of 60½ - 61½" with this mount on installations in our shop. However; this can vary with the diameter of your pulleys.

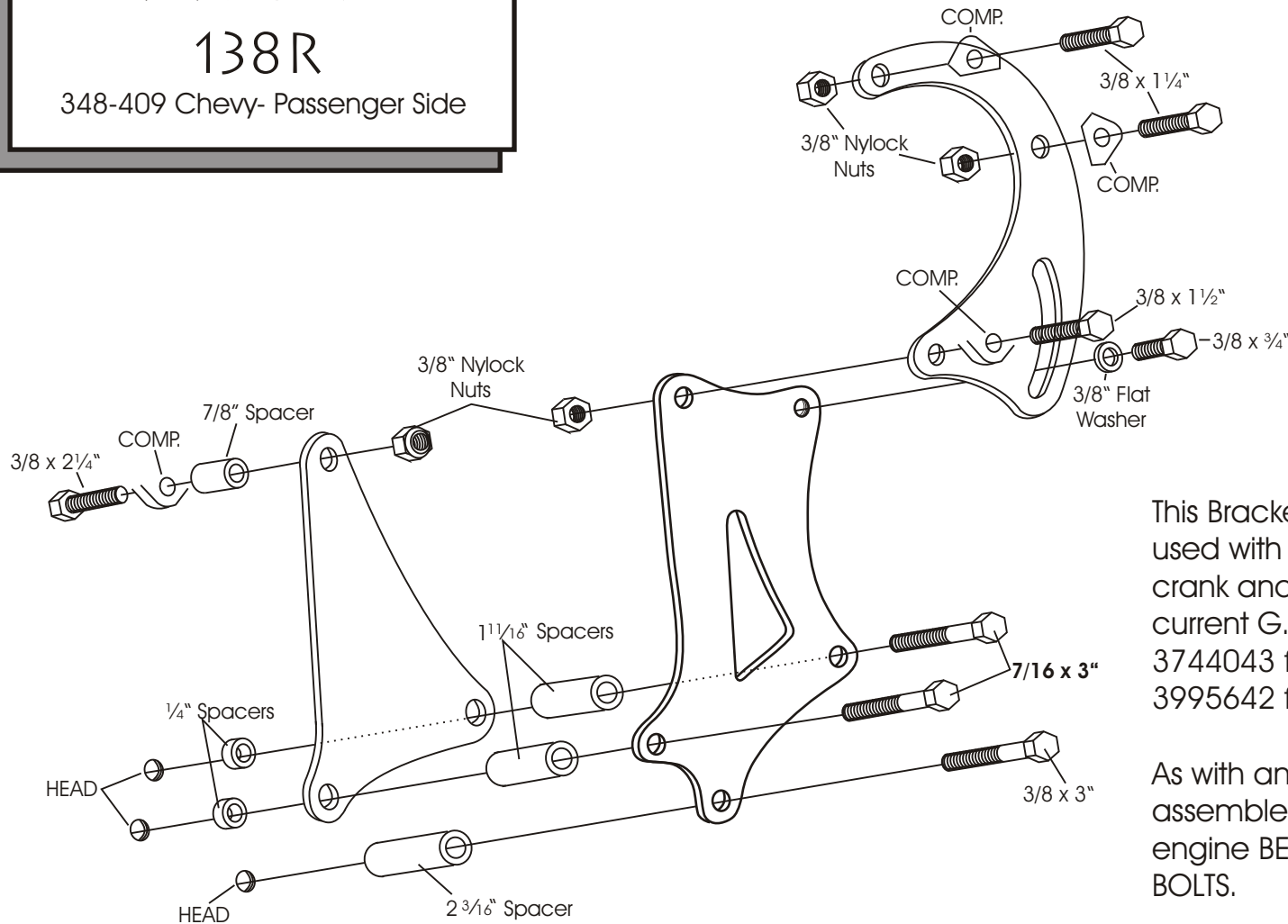

This Bracket was designed to be used with Chevrolet double groove crank and water pump pulleys. The current G.M. Part Numbers are 3744043 for the crank and 3995642 for the water pump.

As with any mount system, assemble all of the brackets to engine BEFORE TIGHTENING THE BOLTS.

**As with any part of this nature, make sure it fits your application before painting or plating. Parts that have been painted, plated, or modified may not be returned.**

A.C.  
COMPRESSOR  
MOUNT  
138R

348-409 Chevy- Passenger Side

**ALAN GROVE COMPONENTS, INC.**  
**27070 METCALF ROAD**  
**LOUISBURG, KS 66053**