

# A.C. COMPRESSOR MOUNT 122R

**Big Block Chevy - Long Water Pump  
Passenger Side - Wide Mount**

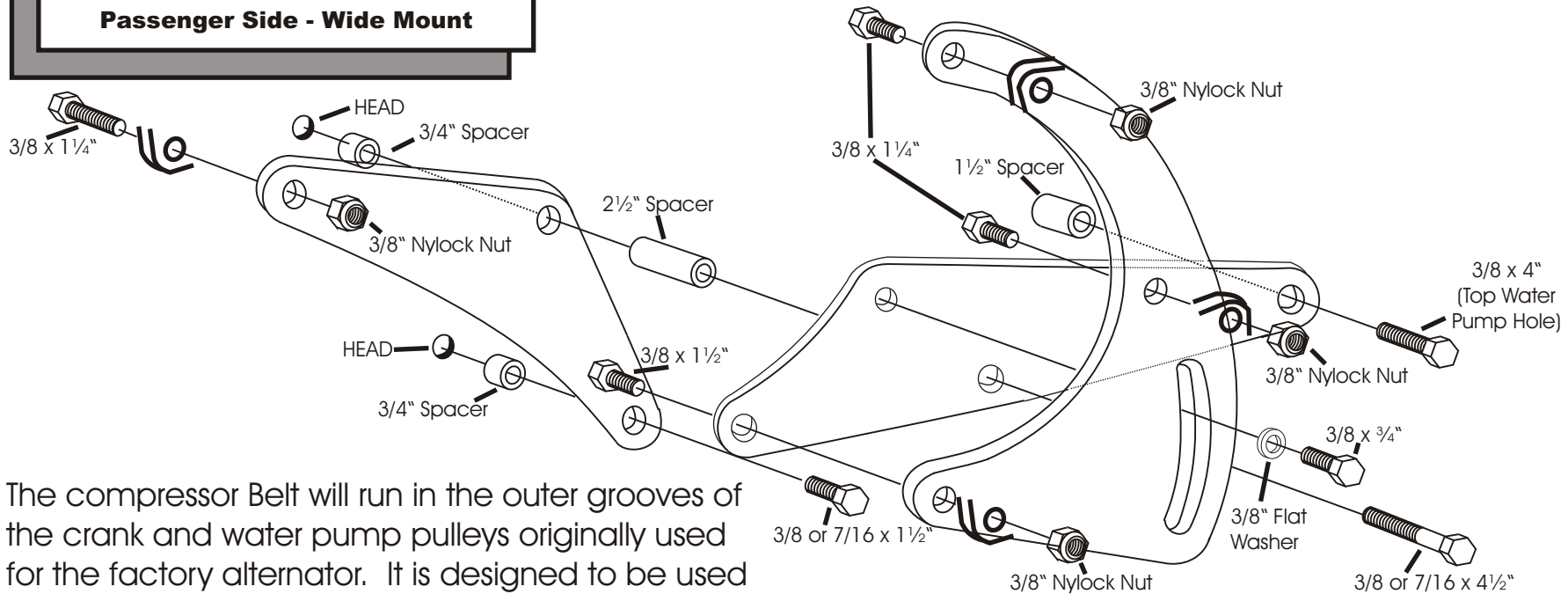

The compressor Belt will run in the outer grooves of the crank and water pump pulleys originally used for the factory alternator. It is designed to be used with our 222L Driver's Side Alternator Bracket.

(We use a belt length of 61-62" with this mount on installations in our shop. However; this can vary with the diameter of your pulleys.)

**As with any part of this nature, make sure it fits your application before painting or plating.**

**NOTE:** Some heads have 3/8" bolt holes and some have 7/16". This kit includes both sizes of bolts for these holes.

If your head has 7/16" it will be necessary to enlarge the corresponding holes in the mount to 7/16".

When installing the mount, start all bolts and mount the compressor before tightening.

A.C.  
COMPRESSOR  
MOUNT  
122R

**Big Block Chevy - Long Water Pump  
Passenger Side - Wide Mount**

**ALAN GROVE COMPONENTS, INC.  
27070 METCALF ROAD  
LOUISBURG, KS 66053**