

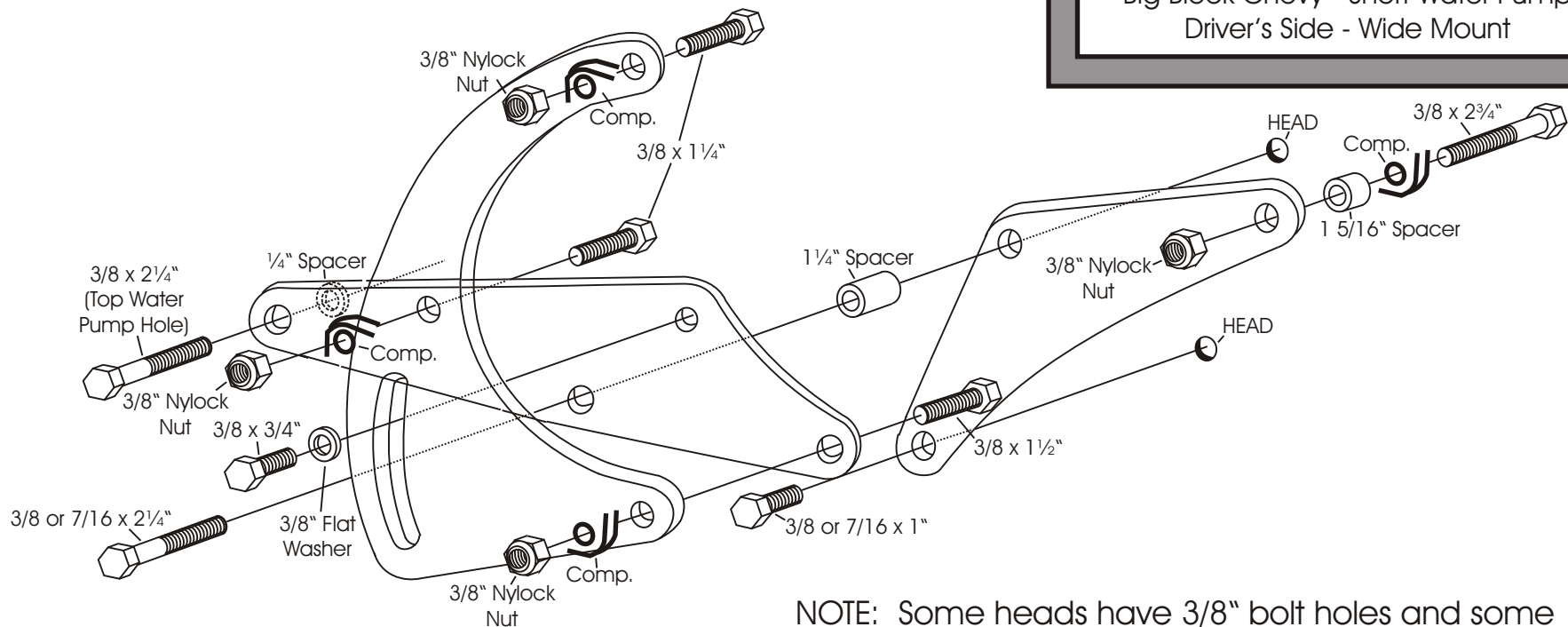

A.C. COMPRESSOR MOUNT 118L

Big Block Chevy - Short Water Pump
Driver's Side - Wide Mount



(We use a belt length of 58-59" with this mount on installations in our shop. However; this can vary with the diameter of your pulleys.)

As with any part of this nature, make sure it fits your application before painting or plating. Parts that have been painted, plated or modified may not be returned.

NOTE: Some heads have 3/8" bolt holes and some have 7/16". This kit includes both sizes of bolts for these holes.

If your head has 7/16" it will be necessary to enlarge the corresponding holes in the mount to 7/16".

When installing the mount, start all bolts and mount the alternator before tightening.

A.C.
COMPRESSOR
MOUNT
118L

Big Block Chevy - Short Water Pump
Driver's Side - Wide Mount

ALAN GROVE COMPONENTS, INC.
27070 METCALF ROAD
LOUISBURG, KS 66053