

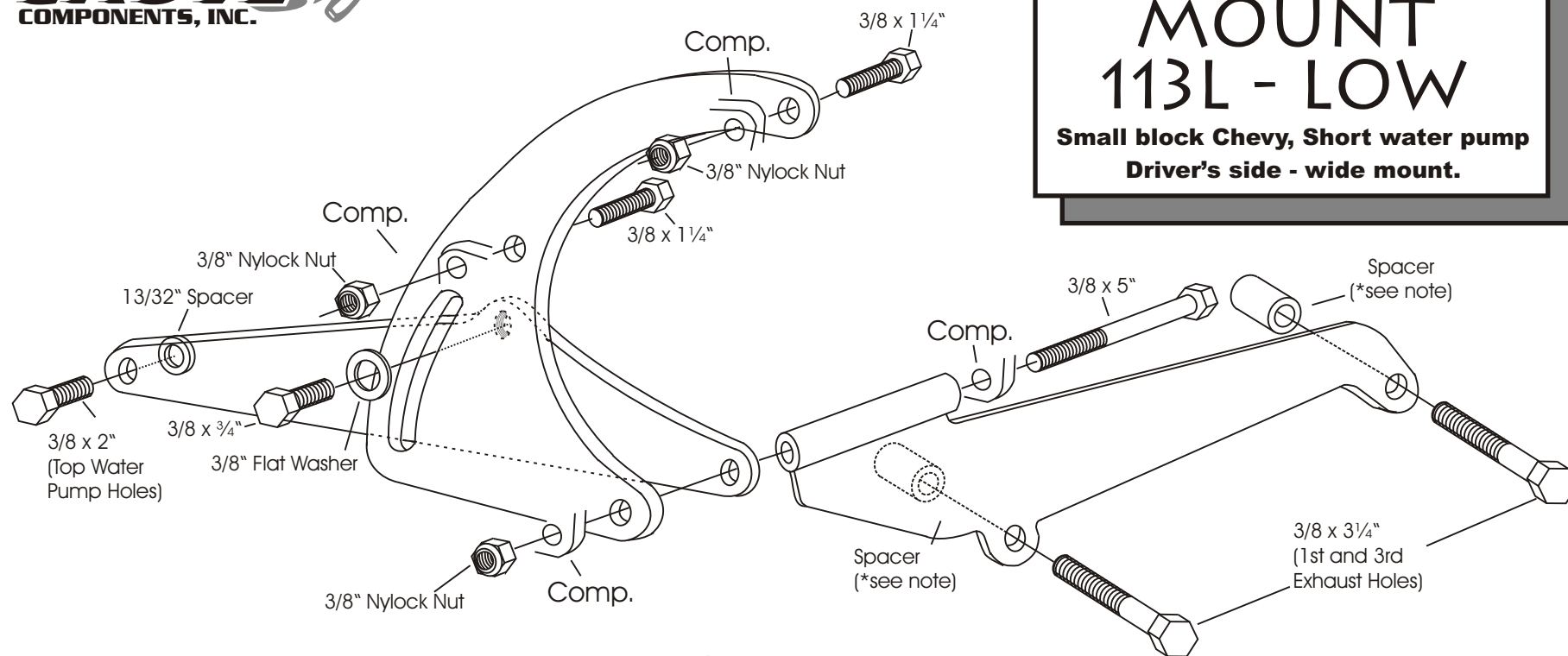

A.C. COMPRESSOR MOUNT 113L - LOW

Small block Chevy, Short water pump
Driver's side - wide mount.



*NOTE: Exhaust Spacers- with HEADERS- use the 2 1/4" long x 5/8" O. D. Spacers. With RAMS HORN MANIFOLDS use the 1/4" long x 3/4" O. D. Spacer at rear hole of bracket and a 1 1/16" long x 3/4" O. D. Spacer at front hole of bracket. With the later DROP-TYPE manifolds use the 1 1/16" long x 3/4" O. D. spacers at both bracket holes. As with any mount system, assemble all of the brackets to engine BEFORE TIGHTENING THE BOLTS.

We use a belt length of 60-61" with this mount on installations in our shop. However; this can vary with the diameter of your pulleys.

As with any part of this nature, make sure it fits your application before painting or plating. Parts that have been painted, plated, or modified may not be returned.

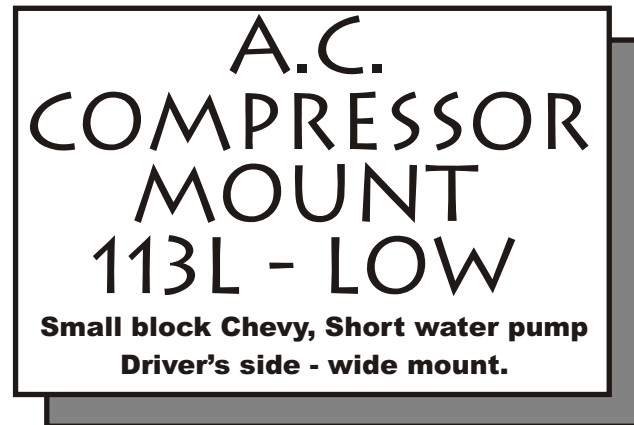

ALAN GROVE COMPONENTS, INC.
27070 METCALF ROAD
LOUISBURG, KS 66053